



34th Street Partnership

500 Fifth Avenue, Suite 1120

New York, NY 10110

Tel: 212-719-3434

Fax: 212-719-3499

34th Street
Partnership

PHOTO / FILM / VIDEO PERMIT APPLICATION

Shoot Day & Date: _____ Park Requested: _____

Time of Shoot: _____ Number of Participants: _____

Time of Set-Up: _____ Time of Break-Down: _____

Applicant Name: _____

Company/Agency/Sponsor: _____

Address: _____ City, State, Zip: _____

Phone: _____ E-mail: _____

Cell/Other: _____ Fax: _____

Purpose of Shoot (publication, display, etc.): _____

Equipment to be used in Park: _____

Requirements:

- ◆ **Contribution of** _____ **and Certificate of Insurance** (naming 34th Street Partnership and The City of New York as additional insureds on a general liability policy) must be received prior to the shoot.
- ◆ A **map** of Herald or Greeley Square indicating details of the shoot.
- ◆ A copy of the finished product on **DVD** for 34th Street Partnership's archives.
- ◆ Recognize 34th Street Partnership as a **credit** at the end of the finished product.
- ◆ Provide _____ **damage deposit** to be held until after a post-shoot evaluation of the site.

I hereby certify that the above information is complete and correct and agree to all requirements set forth.

Signature: _____ Date: _____

Please return to: 34th Street Partnership, attention: Permit Department

For Office Use Only Application Approval by 34th Street Partnership

_____ Date: _____

HERALD SQUARE

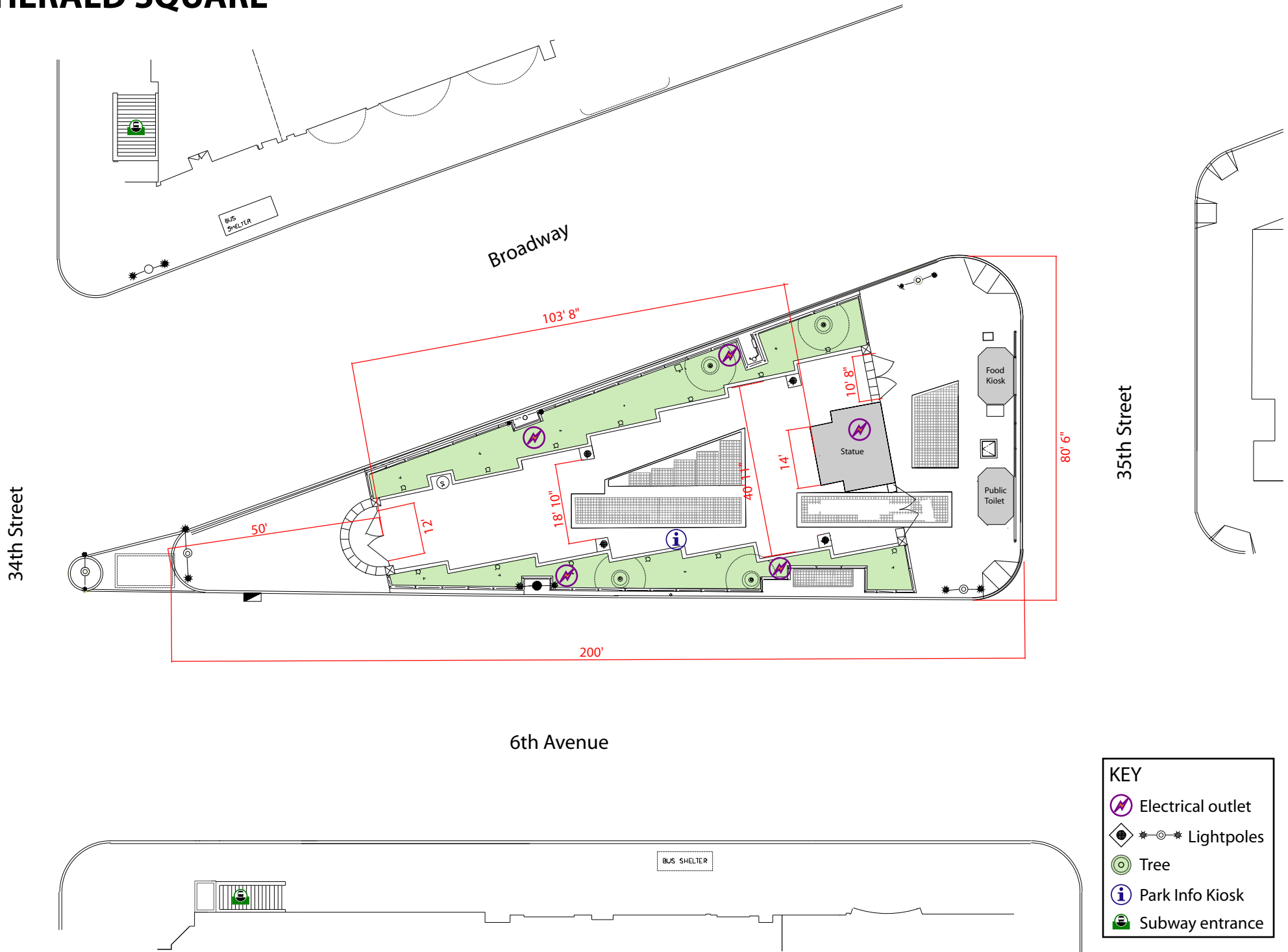

KEY	
	Electrical outlet
	Lightpoles
	Tree
	Park Info Kiosk
	Subway entrance

GREELEY SQUARE

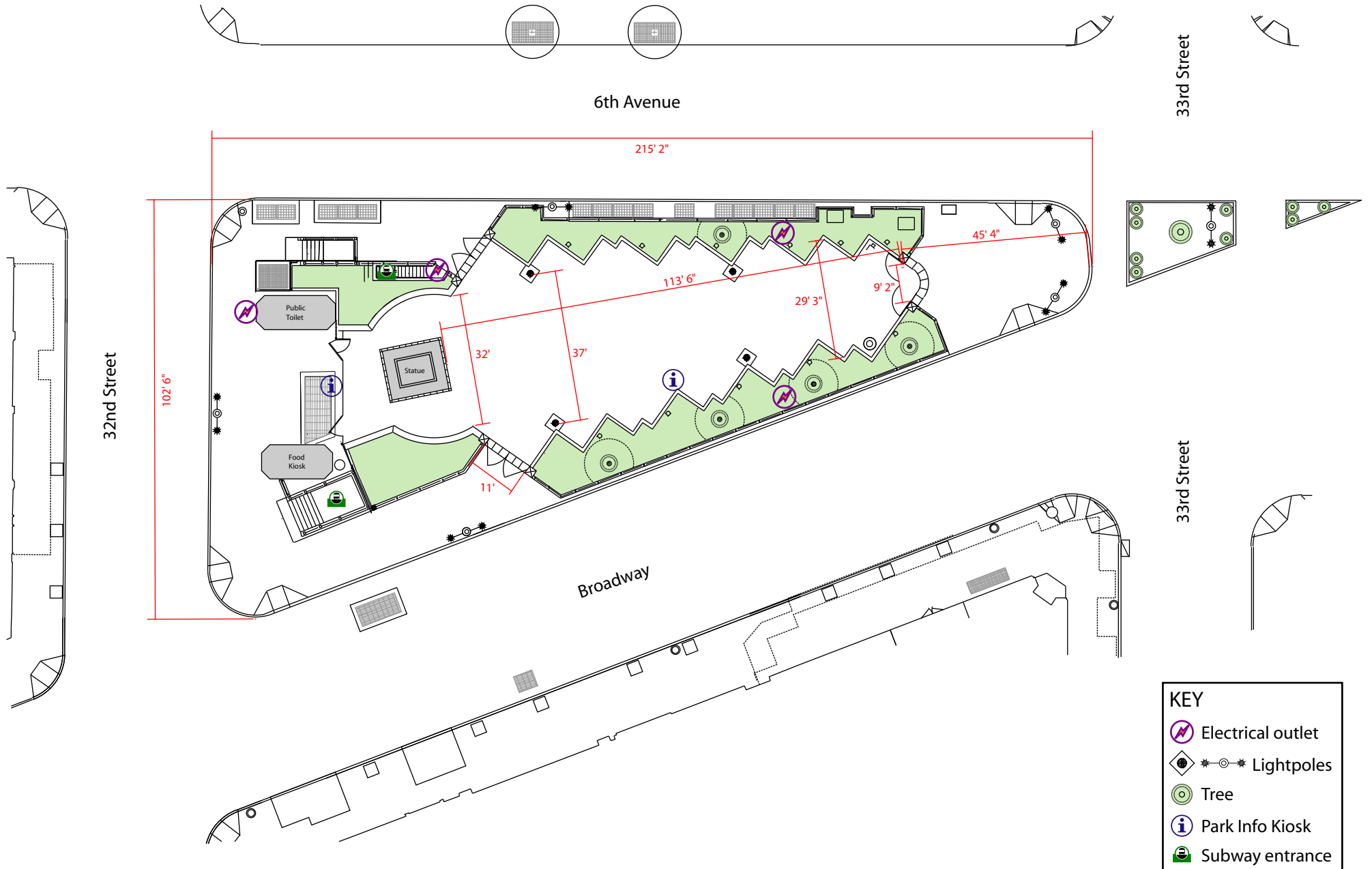

KEY

- Electrical outlet
- Lightpoles
- Tree
- Park Info Kiosk
- Subway entrance